

ITEM NO.	PART NUMBER	DESCRIPTION	QTY.
1	TOP PLATE		1
3	91290A654	M12X220 ALLOY BOLT	2
4	DRIVER SIDE V3	12GA	1
6	PASSENGER SIDE V3		1
7	97646A150	5/16 FLANGE BOLT	2
8	97646A220	3/8 FLANGE BOLT	2
9	98689A118	12MM FLAT WASHER	4
10	90453A117	M12 LOCKNUT	2
11	94895A030	5/16 NUT	2
12	94895A031	3/8 NUT	2
13	91150A113	5/16 SERRATED WASHER	2
14	91150A114	3/8 SERRATED WASHER	2

FITMENT: 2014-CURRENT RZR XP/XPT
NOTES:

- 1) Splicing of the factory differential wires required
- 2) Bracket only. This is only the bracket needed to install RS1/TURBOS/PROXP differential.
- 3) Cutting is required for clearance of the bigger Differential.
- 4) Factory upper a-arm bolt is reused.
- 5) Does not have winch mount holes

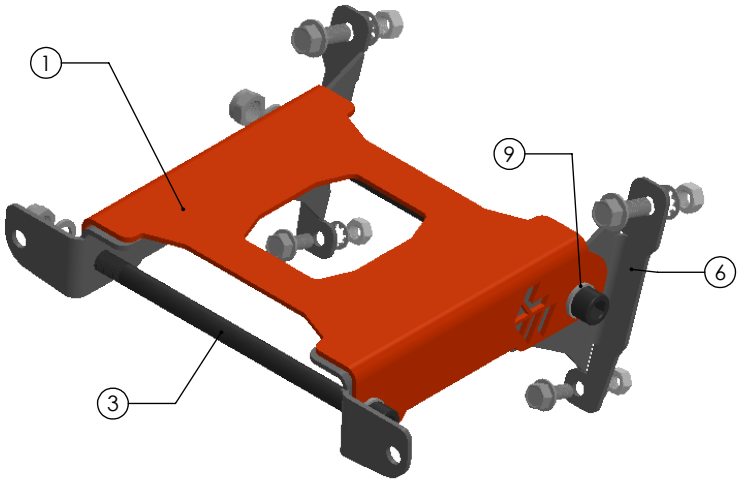
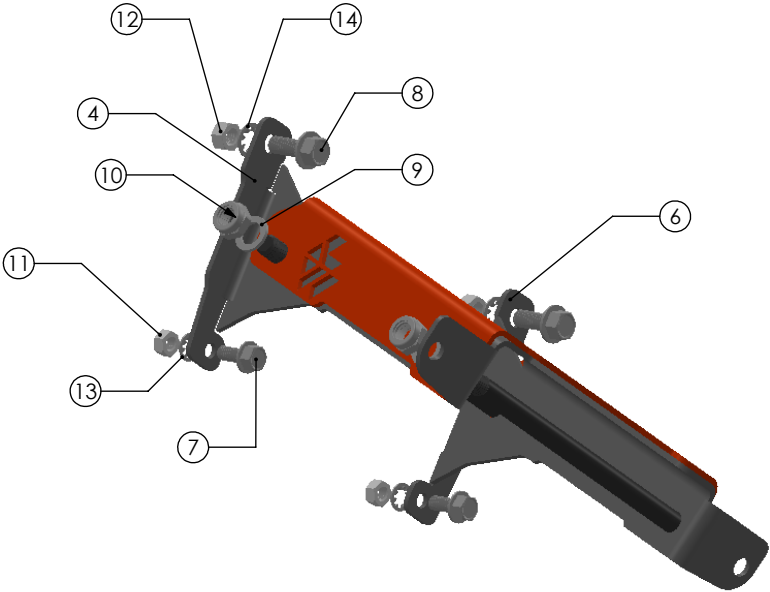

UNLESS OTHERWISE SPECIFIED:

DIMENSIONS ARE IN INCHES
TOLERANCES:
FRACTIONAL $\pm 1/16$
ANGULAR: MACH ± 1 . BEND $\pm .5$
TWO PLACE DECIMAL $\pm .01$
THREE PLACE DECIMAL $\pm .005$



DRAWN: CHET G.

TITLE:

RS1 SWAP ASSEMBLY V3

MATERIAL

SCALE: 1:5

WEIGHT:

SHEET 1 OF 1